

# F18

## Fingerprint Standalone Access Control



F18 is an innovative biometric fingerprint reader for access control application. Offering unparalleled performance by using an advanced algorithm for reliability, precision and excellent matching speed. The F18 features the fastest commercial-based fingerprint matching algorithm and ZK high-performance, high-image quality infrared detection fingerprint sensor. The device offers flexibility to be installed standalone or with any third party access control panels that support standard Wiegand signal. All the operations can be done on the TFT-LCD color screen. The fingerprint image will be displayed on it. That will guide user to put finger on proper position and increase recognition rate. TCP/IP and RS485 are available that the device can be used in different network.



### TFT Color Screen

- Audio-visual indication for acceptance and rejection of valid/invalid fingerprints
- More simple and convenient operation



### Slim and Elegant Design

- Streamlined and slim design for narrow spaces



### Fast and Accurate Fingerprint Algorithm

- 1 touch a-second user recognition
- Store 3,000 fingerprint templates, 30,000 cards and 100,000 transactions



### Easy Installation and Connectivity

- Wiegand input & output
- Network interface by TCP/IP or RS485



### Full Access Control Features

- Webserver
- Anti-passback
- Access control interface for 3rd party electric lock, door sensor, exit button, alarm and doorbell



### Easy Operation and Management

- Work with computer
- Buzzer, 4x4 keypads and doorbell
- Built-in serial and Ethernet ports
- Built-in USB port allows for manual data transfer

# Specifications

Fingerprint Capacity	3000 Templates
Card Capacity	10,000
Transaction Capacity	30,000 Transactions
Sensor	ZK Optical Sensor
Algorithm Version	ZK Finger V9.0&10.0
Communication	RS232/485, TCP/IP, USB-host
Access Control Interface	3rd Party Electric Lock, Door Sensor, Exit Button, Alarm, Doorbell
Wiegand Signal	Input and Output
Display	TFT LCD Color Screen
Interface Styles	Common, Matrix and Magic styles
Standard Function	Webserver, Anti-passback
Optional Function	Mifare Card, HID Prox
Power Supply	12V DC,3A
Operating Temperature	0 °C- 45 °C
Operating Humidity	20%-80%
Dimension(WxDxH)	80×183×42mm

## Optional Accessories



FR1200



RFID Reader



Exit Button



Electric Lock



Battery Backup



RFID Cards & Tags

## Configuration

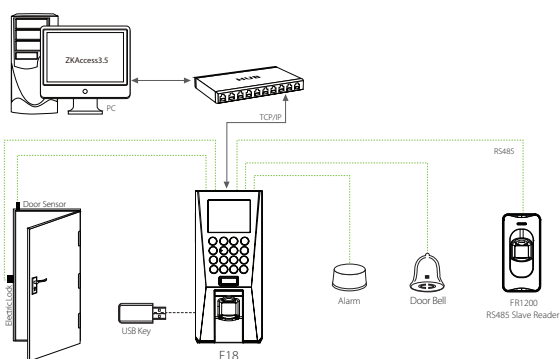

## Dimensions (mm)

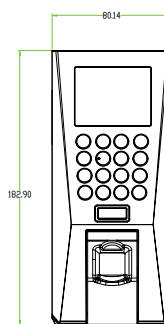
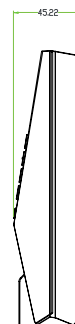

ZKTeco Inc.  
E-mail: [sales@zkteco.co.za](mailto:sales@zkteco.co.za)  
[www.zkteco.co.za](http://www.zkteco.co.za)

© Copyright 2015. ZKTeco Inc. ZKTeco Logo is a registered trademark of ZKTeco or a related company. All other product and company names mentioned are used for identification purposes only and may be the trademarks of their respective owners. All specifications are subject to change without notice. All rights reserved.

